



Apartment

PENNY CLOSE, RAINHAM, RM13 9NE

PCM
£1,300

FEATURES

- One Bedroom
- Spacious Lounge
- Modern Style Bathroom
- Gas Central Heating
- First Floor Flat
- Fitted Kitchen
- Double Glazing
- Communal Garden



1 Bedroom Apartment located in Rainham

Steps Estate Agents are pleased to offer to let this one bedroom first floor flat located in the Rainham Village and Train Station area. Benefitting from a spacious lounge, fitted kitchen and a modern style bathroom. Additionally the apartment has double glazing and gas central heating. this clean and tidy flat needs an early viewing to avoid disappointment.

Call us on

020 8593 5933

dagenham@steps.me.uk

www.steps.me.uk

Council Tax Band

B

FIRST FLOOR

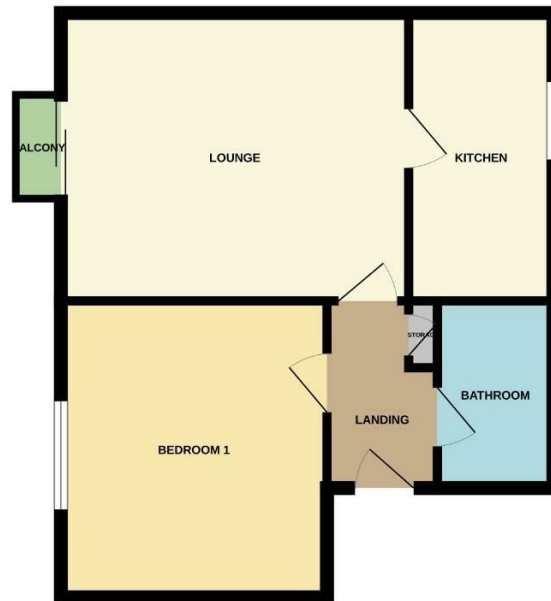

Whilst every attempt has been made to ensure the accuracy of the floorplan contained here, measurements of doors, windows, rooms and any other items are approximate and no responsibility is taken for any error, omission or mis-statement. This plan is for guidance purposes only and should be used as such only for prospective purchase. The services, systems and appliances shown have not been tested and no guarantee as to their operability or efficiency can be given.
Made with Ameyra's iCOCS

Energy Efficiency Rating		Current	Potential
<i>Very energy efficient - lower running costs</i>			
(92 plus) A			
(81-91) B			
(69-80) C		76	76
(55-68) D			
(39-54) E			
(21-38) F			
(1-20) G			
<i>Not energy efficient - higher running costs</i>			
England & Wales		EU Directive	
		2002/91/EC	

Agents Note: Whilst every care has been taken to prepare these particulars, they are for guidance purposes only. All measurements are approximate and are for general guidance purposes only and whilst every care has been taken to ensure their accuracy, they should not be relied upon and potential buyers are advised to recheck the measurements.

